

bar-stock thermowells, tapered shank, with threaded connection, NP250



Thermowells are used to protect the measuring instrument from corrosion, high pressure or high fluid velocity and to allow the measuring instrument removal for recalibration or replacement without affecting the process system. The W50-W60 serie includes bar-stocked thermowells with a threaded process connection and they are suitable for heavy work conditions. These thermowells have a conic immersion length.

9 - Thermowells

Nominal pressure: 3600 psi @ 752°F (250 bar @ 400°C).

Process fluid temperature: -328...+1112°F (-200...+600°C), for std materials.

Total length: 40" max (1000 mm).

Materials : AISI 316 (Cod. 4), AISI 316L (Cod. 5) st.st. bar-stock.

Special materials : Monel 400, Hastelloy C276, Alloy 825, Alloy 625, Duplex SAF 2205, Duplex SAF 2507 bar-stock.

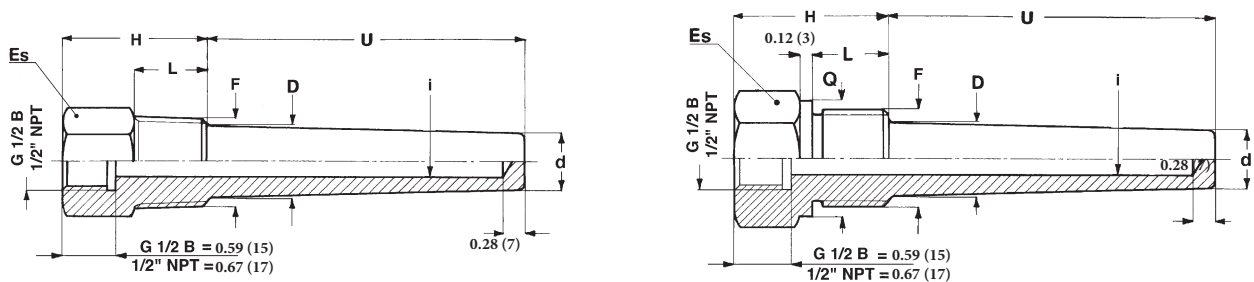

dimensions : inches (mm)

Mod.	Es.	F	i	D	d	H	L	Q
W52	1.06 (27) ⁽¹⁾	53M 3/4" NPT	0.28-0.31-0.35 (7 - 8 - 9)	0.91 (23)	0.71 (18)	1.81 (46)	0.79 (20)	-
			0.39-0.47 (10 - 12)		0.83 (21)			
W53	1.42 (36) ⁽²⁾	63M 1" NPT	0.28-0.31-0.35 (7 - 8 - 9)	1.14 (29)	0.71 (18)	2.01 (51)	0.98 (25)	-
			0.39-0.47 (10 - 12)		0.83 (21)			
W54	1.61 (41)	51M G 3/4 B	0.28-0.31-0.35 (7 - 8 - 9)	0.91 (23)	0.71 (18)	1.81 (46)	0.79 (20)	1.25 (31,7)
			0.39-0.47 (10 - 12)		0.83 (21)			
W54	1.61 (41)	61M G 1 B	0.28-0.31-0.35 (7 - 8 - 9)	1.14 (29)	0.71 (18)	2.01 (51)	0.98 (25)	1.54 (39)
			0.39-0.47 (10 - 12)		0.83 (21)			

(1) For insertion length > 16" (400 mm) and/or special material : round bar stock ϕ 1.18 (30mm) with 0.94" (24 mm) key.

(2) For insertion length > 28" (700 mm) and/or special material : round bar stock ϕ 1.38 (35mm) with 1.06" (27 mm) key.

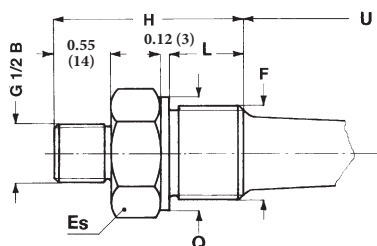
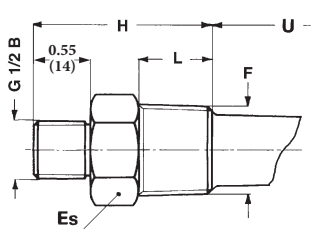

dimensions : inches (mm)

Mod.	Es.	F	i	D	d	H	L	Q
W62	1.06 (27) ⁽¹⁾	53M 3/4" NPT	0.28-0.31-0.35 (7 - 8 - 9)	0.91 (23)	0.71 (18)	2.24 (57)	0.79 (20)	
			0.39-0.47 (10 - 12)		0.83 (21)			
W63	1.42 (36) ⁽²⁾	63M 1" NPT	0.28-0.31-0.35 (7 - 8 - 9)	1.14 (29)	0.71 (18)	2.44 (62)	0.98 (25)	
			0.39-0.47 (10 - 12)		0.83 (21)			
W64	1.61 (41)	51M G 3/4 B	0.28-0.31-0.35 (7 - 8 - 9)	0.91 (23)	0.71 (18)	2.24 (57)	0.79 (20)	1.25 (31,7)
			0.39-0.47 (10 - 12)		0.83 (21)			
W64	1.61 (41)	61M G 1 B	0.28-0.31-0.35 (7 - 8 - 9)	1.14 (29)	0.71 (18)	2.44 (62)	0.98 (25)	1.54 (39)
			0.39-0.47 (10 - 12)		0.83 (21)			

(1) For insertion length > 16" (400 mm) and/or special material :
round bar stock ϕ 1.18 (30mm) with 0.94" (24 mm) key.

(2) For insertion length > 28" (700 mm) and/or special material :
round bar stock ϕ 1.38 (35mm) with 1.06" (27 mm) key.

OPTIONS

P02 -	Oxygen service
E30 -	NACE MR0103 - MR0175 (ISO15156) certificate
TC1 -	Plug and chain (1)
NIP -	Nipple with coupling (1)
CVK -	ASME PTC 19.3 TW calculation (1)

i
070 - ϕ 0.28 (7)
080 - ϕ 0.31 (8)
090 - ϕ 0.35 (9)
100 - ϕ 0.39 (10)
120 - ϕ 0.47 (12)

(1) Drawings and details in the "Thermowells information" sheet.

"HOW TO ORDER" SEQUENCE

Section / Model / Material / Instrument connection / Process connection / Insertion hole / Insertion length	Extension length	Options
9 W52 4 41F - G 1/2 51M 070		P02...CVK
W53 5 43M - 1/2 NPT 61M 080		
W54 41M - G 1/2 B 53M 090		
W62 63M 100		
W63 120		
W64		