

OPERATING INSTRUCTIONS

1. Before using, loose the fixing rod and the rotary rod to their top end.

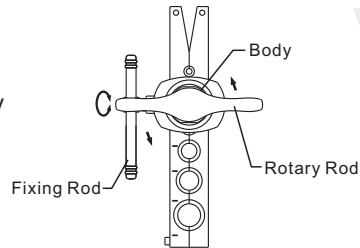

2. Open the tube expander bar and put the tube into the right place according to its required dimension.

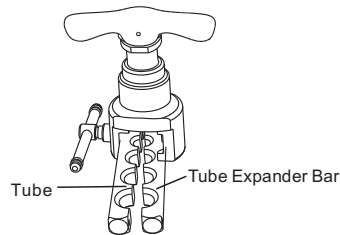

3. After being placed, the tube should be about 1 mm higher than the plane of the tube expander bar.

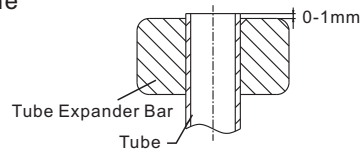

4. Aim the arrow at the dimension mark and then lock tightly the fixing rod.

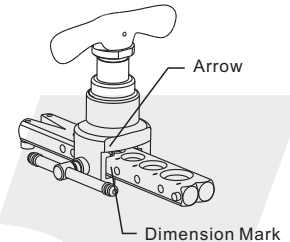

5. Turn down clockwise the rotary rod until it loose automatically. Then turn 2 or 3 rounds to make the horn aperture smooth and bright.

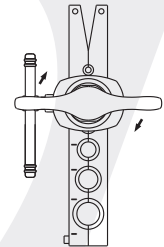

6. After the operation was completed, turn backward the rotary rod up to the top end. Then, loosen the fixing rod and open the tube expander bar to take the tube out.

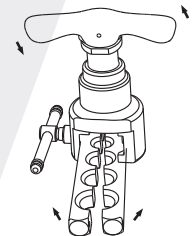

▲ Caution: Please pay attention that the backward turn isn't permitted before the elastic pole was parked into its initial hole, or it may hurt your hands!

MAINTENANCE INSTRUCTIONS

1. Keep 45° place of the circular cone clean away from copper dust after using.

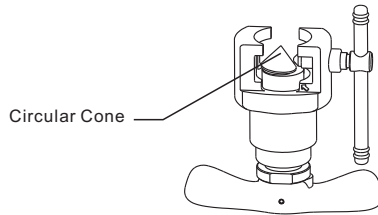

2. Add lubricant frequently on the fixing rod and rotary rod.
3. Be sure to add frequently the tallow on inside bearings and the connection of the rotary rod as well as screw.

APPLICATION

1. For VFT-808-I 3/16", 1/4", 5/16", 3/8", 1/2", 5/8", 3/4"
2. For VFT-808-MI 6mm, 8 mm, 10 mm, 12 mm, 14 mm, 16 mm, 19 mm
& 3/16", 1/4", 5/16", 3/8", 1/2", 5/8", 3/4"